

# KAMALESH SEAL

B. Tech (Civil), Chartered Engineer  
Licensed Building Surveyor  
Enappened structural Engineer of  
The Kolkata Municipal Corporation

98300 24736 (M)  
90070 90736 (M)  
70032 58468 (M)  
E-mail : kseal.associates@gmail.com

SITE PLAN AT PREMISES NO.- 54B, HARI GHOSE STREET, KOLKATA - 700006, KMC WARD NO.- 017, BOROUGH - II, P.S.- BURTOLLA.

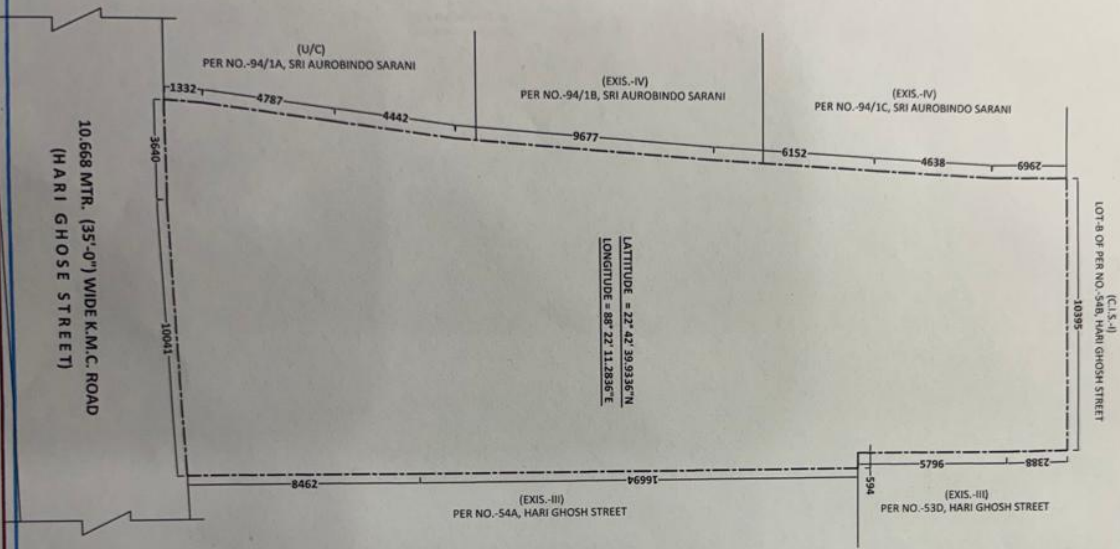

10 668 MTR. (35'-0") WIDE K.M.C. ROAD  
(HARI GHOSE STREET)

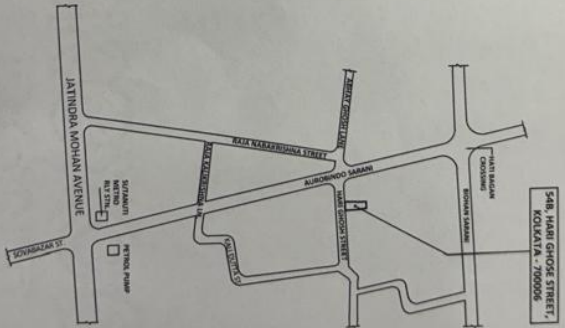

LOCATION PLAN

*Kamalesh Seal*  
KAMALESH SEAL, B. Tech (Civil)  
L.B.S. No.:- 1020 (Class-I)  
The Kolkata Municipal Corporation

SIGNATURE OF L.B.S.

Office : 22A, Raja Naba Krishna Street, Kolkata - 700 005 (Near Jalpuria College)

Resi : BD-374, Sail Lake City, Sector-1, Kolkata - 700 064

ARCHITECTS • ENGINEERS • CONSULTANTS • CONTRACTORS